

Chassis-mount Filters

X-,Z-Series

- Optimized differential and common mode performance filter to clean up switch mode power supplies and similar equipment



according IEC 950



Type	Max.current UL/VDE	Inductance	Capacity		Dimensions (mm)				
			C _x	C _y	A	B	C	D	E
3EX1	3A/2A	2x2,3mH	0,27+0,1μF	2x4nF	76,7	46,7	29,5	60,3	70,8
3EZ1*	3A/2A	2x13,77mH	0,47+0,27μF	2x4nF	89,9	52,8	33,3	74,6	85,1

Max. leakage current line to ground 0.5 mA at 250 VAC/50 Hz

*Suitable for frequency applications

For medical Applications

Type	Max.current UL/VDE	Inductance	Capacity		Dimensions (mm)				
			C _x	C _y	A	B	C	D	E
3EHZ1	3A/2A	2x13,77mH	0,47+0,27μF	-	89,9	52,8	33,3	74,6	85,1

Max. leakage current line to ground 250 VAC/50 Hz 5 μA

X-Series -Normal attenuation

Example: RFI suppression in electronic devices acc. to FCC Part 15J, Class B.

Z-Series -Very high attenuation

Example: RFI suppression in electronic devices also equipped with switching power supplies according to VDE 0871, Class B.

Electrical Schematic

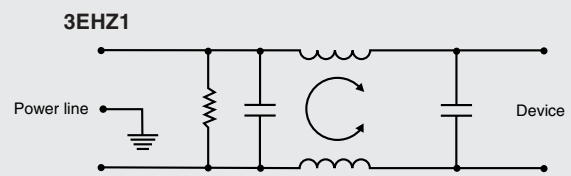
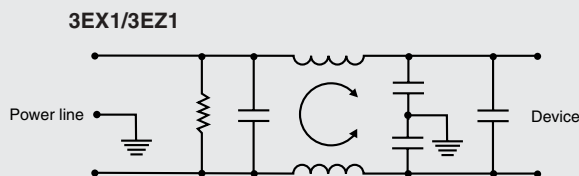

Case Styles and typ. Sizes

For PCB mounting also with plastic case available (see XP, YP, ZP Series)



Faston 6,35 Mounting holes 4,8 Dia

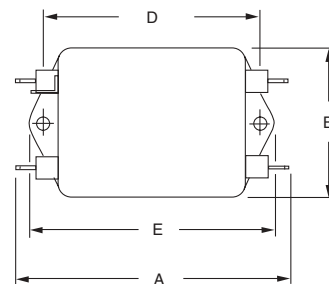
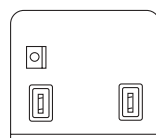

Typ. Insertion Loss

asym. — sym. —

