

# DDL F SERIES

D-SUB  
STRAIGHT PCB  
HIGH PROFILE  
WITH FERRITE

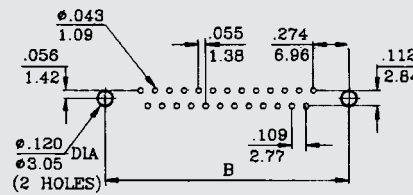

DDL F - B25SB - X - 000 **EXAMPLE**

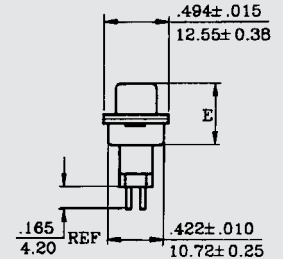
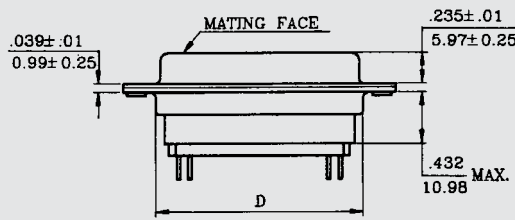
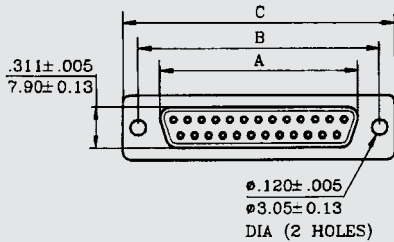

PCB HOLE PATTERNS

## DIMENSIONS

| SHELL SIZE | A              | B              | C              | D              | E              |
|------------|----------------|----------------|----------------|----------------|----------------|
| 9 (E)      | 0.643<br>16.33 | 0.984<br>24.99 | 1.213<br>30.81 | 0.759<br>19.28 | 0.429<br>10.90 |
| 15 (A)     | 0.971<br>24.66 | 1.312<br>33.32 | 1.541<br>39.14 | 1.083<br>25.51 | 0.429<br>10.90 |
| 25 (B)     | 1.511<br>38.38 | 1.852<br>47.04 | 2.088<br>53.04 | 1.625<br>41.28 | 0.429<br>10.90 |
| 37 (C)     | 2.159<br>54.84 | 2.500<br>63.50 | 2.729<br>69.32 | 2.272<br>57.71 | 0.429<br>10.90 |

## FERRITE SPECIFICATIONS

| ITEM    | Measure value | Test Frequency |
|---------|---------------|----------------|
| Z (ohm) | 20 MIN        | 30 MHz         |
| Z (ohm) | 30 MIN        | 50 MHz         |
| Z (ohm) | 50 MIN        | 100 MHz        |

To return to this page use return button in your browser

• MOUNTING OPTIONS:  
SEE PAGE 28

## HOW TO ORDER

| SERIE               | SHELL            | PINS                | M/F     | MOUNTING OPTIONS | CONTACT PLATING  | INSULATOR COLOR                                 | SHELL FINISH  |
|---------------------|------------------|---------------------|---------|------------------|--|---|---|
| <b>EXAMPLE</b> DDLF | B                | 25                  | SB      | X                | 0  | 0   | 0   |
| DDL F               | E<br>A<br>B<br>C | 9<br>15<br>25<br>37 | P<br>SB | *X<br>PAGE.28    | *0 = G/F<br>4 = 15μ"<br>1 = SEL G/F<br>5 = 20μ"<br>2 = 5μ"<br>6 = 30μ"<br>3 = 10μ" | *0 = BLACK<br>1 = WHITE<br>2 = BLUE<br>3 = GRAY | *0 = TIN<br>1 = NICKEL<br>2 = ZINC<br>3 = ALL PLASTIC |

\*STANDARD