

DC SERIES

D-SUB CONNECTOR CRIMP TYPE

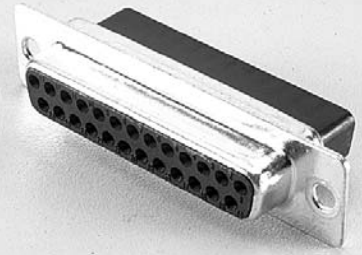

DC - B25SB - X - X00 ◀ EXAMPLE

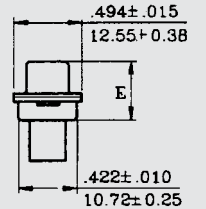
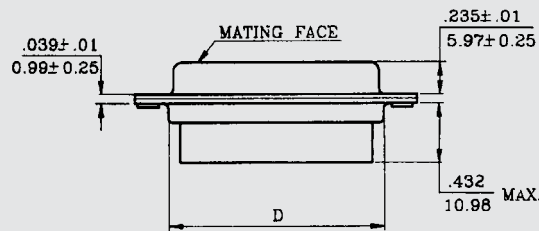
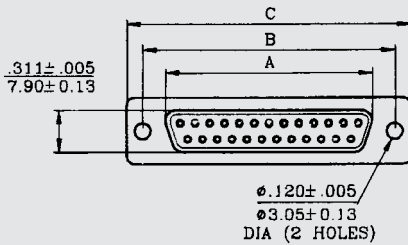

DIMENSIONS

SHELL SIZE	A	B	C	D	E
	0.010 0.25	0.005 0.13	0.015 0.38	0.010 0.25	0.015 0.38
9 (E)	0.643 16.33	0.984 24.99	1.213 30.81	0.759 19.28	0.429 10.90
15 (A)	0.971 24.66	1.312 33.32	1.541 39.14	1.083 27.51	0.429 10.90
19 (G)	1.208 30.68	1.526 38.76	1.764 44.81	1.299 32.99	0.429 10.90
25 (B)	1.511 38.38	1.852 47.04	2.088 53.04	1.625 41.28	0.429 10.90
37 (C)	2.159 54.84	2.500 63.50	2.729 69.32	2.272 57.71	0.429 10.90
50 (D)	2.064 52.43	2.406 61.11	2.635 66.93	2.178 55.32	0.429 10.90

CRIMP CONTACTS

MALE: DCT-P-1

FEMALE: DCT-SB-1

SUPPLIED ON REEL OF 5K PCS

To return to this page
use return button in your
browser

● MOUNTING OPTIONS:
SEE PAGE 28

HOW TO ORDER

SERIE	SHELL	PINS	M/F	MOUNTING OPTIONS	CONTACT PLATING	INSULATOR COLOR	SHELL FINISH
EXAMPLE → DC	B	25	SB	X	X	0	.0
DC	E A G B C D	9 15 19 25 37 50	P SB	*X PAGE 28	0 = G/F 4 = 15μ" 1 = SEL G/F 5 = 20μ" 2 = 5μ" 6 = 30μ" 3 = 10μ" *X = CRIMP	*0 = BLACK 1 = WHITE 2 = BLUE 3 = GRAY	*0 = TIN 1 = NICKEL 2 = ZINC 3 = ALL PLASTIC

*STANDARD