

# DMR, DMRM, DMRL SERIES

## D-SUB MACHINED PIN CONNECTOR RIGHT ANGLE TYPE

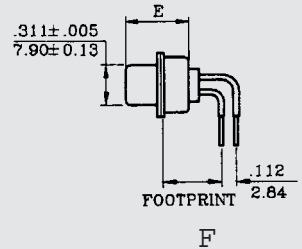

DMRM - B25S - X - 000 ◀ EXAMPLE

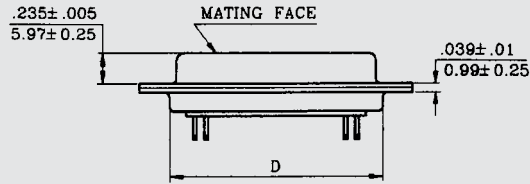
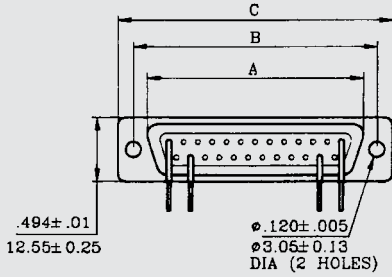

## DIMENSIONS

SHELL SIZE	A 0.010 0.25	B 0.005 0.13	C 0.015 0.38	D 0.010 0.25	E 0.015 0.38
9 (E)	0.643 16.33	0.984 24.99	1.213 30.81	0.759 19.28	0.429 10.90
15 (A)	0.971 24.66	1.312 33.32	1.541 39.14	1.083 27.51	0.429 10.90
25 (B)	1.511 38.38	1.852 47.04	2.088 53.04	1.625 41.28	0.429 10.90
37 (C)	2.159 54.84	2.500 63.50	2.729 69.32	2.272 57.71	0.429 10.90
50 (D)	2.064 52.43	2.406 61.11	2.635 66.93	2.178 55.32	0.429 10.90

SERIE	F	DESCRIPTION
DMR	0.283" 7.19MM	SHORT AMERICAN
DMRM	0.370" 9.40MM	EUROPEAN
DMRL	0.545" 13.84MM	LONG AMERICAN

To return to this page  
use return button in  
your browser

● MOUNTING OPTIONS:  
SEE PAGE 28

## HOW TO ORDER

SERIE	SHELL	PINS	M/F	MOUNTING OPTIONS	CONTACT PLATING	INSULATOR COLOR	SHELL FINISH
EXAMPLE → DMRM	B	25	S	X	0	0	0
DMR	E	9	P	*X	*0 = G/F 4 = 15μ"	*0 = BLACK	*0 = TIN
*DMRM	A	15	S	PAGE 28	1 = SEL G/F 5 = 20μ"	1 = WHITE	1 = NICKEL
DMRL	B	25			2 = 5μ" 6 = 30μ"	2 = BLUE	2 = ZINC
	C	37			3 = 10μ"	3 = GRAY	3 = ALL PLASTIC
	D	50					

\*STANDARD