

Technical Data

- through-hole or SMD
- 50mA/24VDC
- single pole/momentary
- 10.000.000 operations life time
- IP67 sealing
- temperature range:
 - low temp: -40/+115°C
 - high temp: -40/+160°C

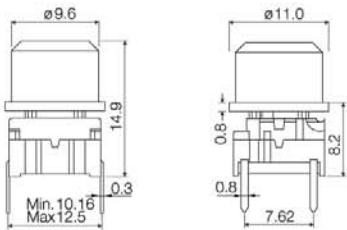

Dimensions (through-hole)



PCB layout

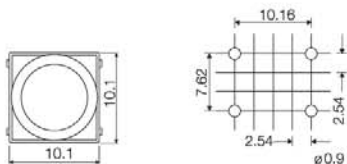

Dimensions (w/LED)

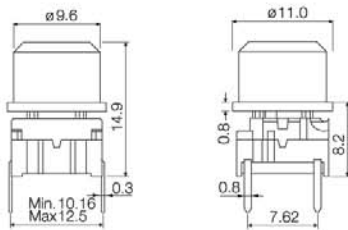

PCB layout (top view)

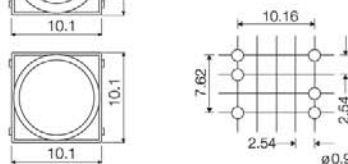

Dimensions (SMD)

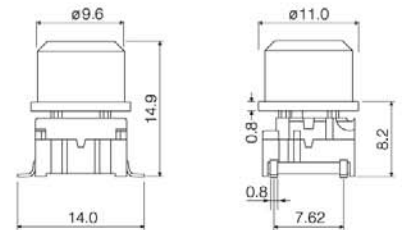

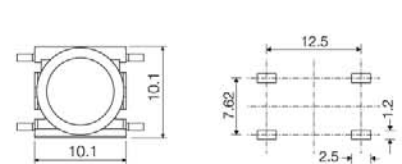

PCB layout



How to order

3 F	<input type="checkbox"/>	<input type="checkbox"/>	+	1 D	<input type="checkbox"/>	<input type="checkbox"/>	<input type="checkbox"/>
Switch	Mounting	L 6 low temp.		Cap	00 blue	30 ultra blue	50 metal dark blue
	T through-hole	H 9 high temp.			02 green	40 dusty blue	53 metal light grey
	S surface mount				03 grey	42 aqua blue	57 metal dark grey
					04 yellow	32 mint green	58 metal bordeaux
					06 white	33 tele grey	
					08 red	34 melon	
					09 black	38 noble red	

3 F	T	<input type="checkbox"/>	<input type="checkbox"/>	+	<input type="checkbox"/>	<input type="checkbox"/>	<input type="checkbox"/>
Switch	Mounting	L 6 low temp.	LED		Cap 1D	11 transparent	Lens
	T through-hole	H 9 high temp.	00 blue			16 frosted white	
			20 green		Cap 1E		00 blue
			40 yellow				02 green
			60 white		Cap 1F		03 grey
			80 red				04 yellow
			2040 green/yellow				06 white
			8020 red/green				08 red
			8040 red/yellow				09 black

Keycaps shown on this page can also be used on illumec™ switch 4F - see page 13

Ordering example: 3FTL620 + 1E032