

Basic module applies to all versions

Low temp.

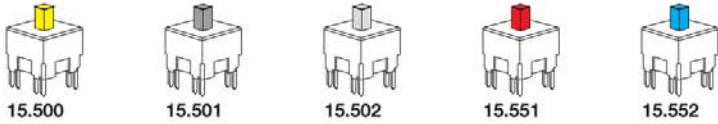

High temp.

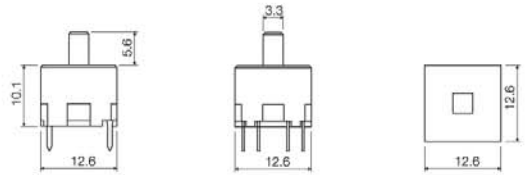
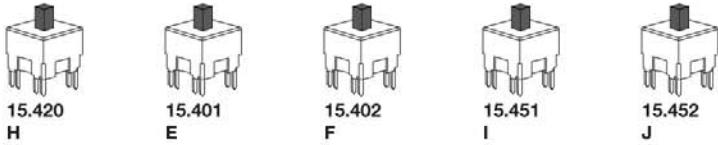

Part no:

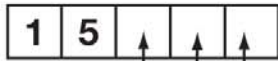

Temperature:
5: low temp.
4: high temp.

Switch function:
0: momentary
5: alternate

Terminal:
1: silver
2: gold
0: quiet version, silver

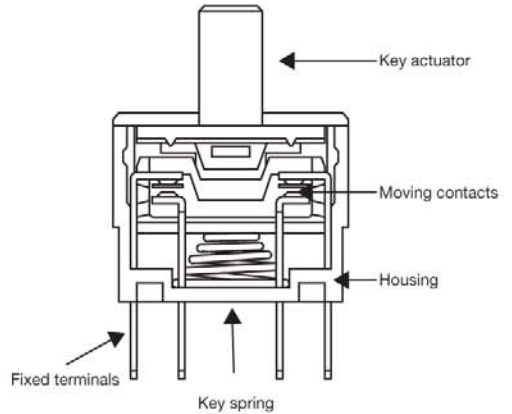

PCB Mounting Hole Dimensions Basic Switch	Circuit diagram (topview)	PCB Mounting Hole Dimensions (w/Extender 16250)	Functional diagram

Wiring Diagram

Select the contact function you desire - and design your PC board accordingly

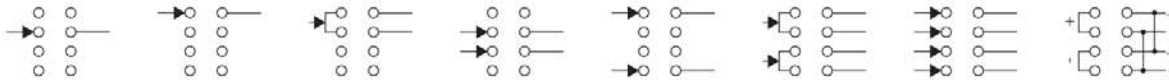

1 make contact 1 break contact 1 change over contact 2 make contacts 2 break contacts 2 change over contacts 2 make and 2 break reverse polarity

How to assemble

unimec™
15XXX + 16300 +
16310

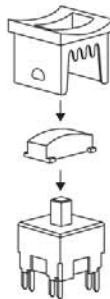

unimec™
15XXX + 16270 +
16300 + 16324

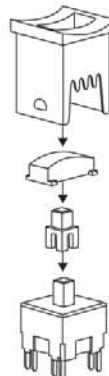

Operating Force (Typical example)

